

## Light Horse Schedule



# 127<sup>th</sup> Ashbourne Show

Qualifiers for Horse of the Year Show – Ridden Hunter,  
Show Cobs, Hacks, Private Driving and Horse Working  
Hunters, RoR Tattersalls, BDS Driving, NPS M & M &  
Silver Medal & VHS

**The Polo Ground  
Osmaston, Nr Ashbourne, DE6 1LU  
Saturday 18<sup>th</sup> August 2018**

Light Horse Entries Secretary - Cheryl Scott  
Tel: 07966 625994

**Entries close 27th July 2018**

**Website: [www.ashbourneshow.co.uk](http://www.ashbourneshow.co.uk)**

Livestock schedules available on the website

Organised by Ashbourne Shire Horse Society

**TIMETABLE (these are Not Before times)**

**MAIN RING**

8.00 a.m.	Classes 501 - 504	Horse of the Year Show Ridden Hunters & Championship
11 a.m.	Classes 505 - 507	Horse of the Year Show & BDS Driving Classes

**RING 2**

8.00 a.m.	Class 508	The Eques-Train Unaffiliated Working Hunter
9.30 a.m.	Classes 509 – 510	Novice & Restricted Working Hunters
11.00 a.m.	Class 511	Horse of the Year Show Working Hunters
1.30 p.m.	Classes 512 – 515	The Eques-Train Working Hunter Training Stakes
3.30 p.m.	Class 516	NPS Mountain & Moorland Working Hunter Pony

**RING 3**

8.00 a.m.	Classes 517 – 520	Horse of the Year Show Cobs & Championship, Novice & Amateur Cobs
11.00 a.m.	Stand Down	Available for the Hunters if running over in the main ring
12.00 p.m.	Classes 521 – 522	Horse of the Year Show Hacks & Championship
3.00 p.m.	Class 523	Novice Riding Horse
3.30 p.m.	Classes 524 - 525	Race Horse to Riding Horse In hand & Ridden
4.15 p.m.	Classes 526 – 527	Riding Club Show Horse & Novice Ridden Hunter (Unaffiliated)

**RING 4**

8.00 a.m.	Classes 528 – 531	NPS Ridden M&M and Championship
10.00am	Classes 532 - 534	The Eques-Train Local Rider Classes and Championship
11.15 a.m.	Classes 535 - 536	Open in Hand Horses & Ponies
12.45 p.m.	Class 537	The Blue Chip Flat Ridden Sport Horse Class
2.30 p.m.	Classes 538 - 541	Mountain & Moorland In-hand and Championships
Follow on	CHAMPIONSHIP	Inhand M & M kindly sponsored by Meynell Saddlery
4.15p.m	Classes 542 - 543	Veteran Horse Society Classes – Inhand & Ridden - Area Qualifier

All the above times are approximate times only. Classes **will not** start before the times shown.

**Course builder: Mr D Norlander**

**MEMBERSHIP OF THE ASHBOURNE SHIRE HORSE SOCIETY**

The Ashbourne Shire Horse Society would be pleased to welcome new members to the Society upon payment of the Annual Subscription of £30. Membership entitles you to entrance for 1 member, 1 guest and two children under the age of 15, entry to the members' enclosure, restaurant, bar and grandstand. You will also receive reduced entry fees.

## ENTRY RULES

### **Entries close 27<sup>th</sup> July 2018**

Entries **received** by this date will be charged at the rate shown in the schedule

Late Entries **received** between 28<sup>th</sup> July and 3<sup>th</sup> August 2018 **ONLINE ONLY** will be charged at **double** the entry rate shown in the schedule (for Horse of the Year Show classes, the Horse of the Year Show contribution is not doubled)

**ONLINE ENTRIES AVAILABLE – [www.ashbourneshow.co.uk](http://www.ashbourneshow.co.uk)**

### **NO ENTRIES RECEIVED AFTER 3rd AUGUST 2018 WILL BE ACCEPTED**

PLEASE NOTE IF ENTERING HORSE OF THE YEAR SHOW QUALIFYING CLASSES YOU **MUST** BE REGISTERED ONLINE VIA HOYS.CO.UK BEFORE ENTERING ASHBOURNE SHOW

Entries for the following classes can also be taken on the day from any competitor **already** entered in another class. Any such entries will be charged at double the standard entry rate –unaffiliated working hunter, local riders, M&M and veterans. Entries on the day for the WHP, WHP, and the training stakes will be charged at £15 per entry.

### **WRISTBAND AND VEHICLE PASS ALLOCATION**

Exhibitor's entrance wristbands and vehicle passes will be sent out prior to the show and are allocated as follows:

1 Animal -	2 Wristbands, 1 Vehicle Pass
2 - 3 Animals -	3 Wristbands, 1 Vehicle Pass
4 - 5 Animals -	4 Wristbands, 2 Vehicle Passes
6 - 7 Animals -	5 Wristbands, 2 Vehicle Passes

**Please note that no admittance will be granted to the showground if you are not wearing the supplied wristband.** Additional admission wristbands for friends and supporters can be purchased at a reduced rate of £10 **ONLY** if purchased at the time of entry.

**The official photographer for Ashbourne Show is AF1 Photography, photos will be available on the day or via their website – [af1.photography](http://af1.photography)**

**There will be an onsite Farrier available on the day  
Chris Hole - 07976 485409**

## HORSE OF THE YEAR SHOW RIDDEN HUNTER CLASSES

To be judged in the Main Ring at 8.00 am

### Judges

**Mr David Ingle - Northamptonshire (ride)**

**Mrs J Macinnes - Penrith (conformation)**

Entry Fees: £38 - includes £12 Horse of the Year Show contribution (Ashbourne Shire Horse Society Members £30)

Prizes: 1<sup>st</sup> £50, 2<sup>nd</sup> £40, 3<sup>rd</sup> £30, 4<sup>th</sup> £20, 5<sup>th</sup> £15, 6<sup>th</sup> £10

These classes are held under the rules of The British Show Horse Association (see regulation 20), however the general rules as set out in the Horse of the Year Show Rulebooks take precedence, a copy of which can be downloaded from [www.hoys.co.uk](http://www.hoys.co.uk). All Riders, Owners, and Producers must be Members of the British Show Horse Association. Horses must be registered with the British Show Horse Association.

Competitors must enter their horses in the appropriate sections, but class 501 and class 502 will be judged first and the judges shall have the power to transfer exhibits to class 503 and class 504 if they deem it necessary.

### **CLASS 501 – Horse of the Year Show Qualifier 2018 – Small Show Hunter**

Mare or gelding, 4 years old or over, exceeding 148cm (14.2hh approx.) but not exceeding 158 cm (15.2hh approx.) to be ridden. Entries in this Class may not compete in the Show Hunter of the Year, and vice versa. When registering with the BSHA, a current Joint Measurement Board Height Certificate must be done before application.

### **CLASS 502 - Horse of the Year Show Qualifier 2018 – Catplant Group of Companies Ltd. Lightweight Show Hunter**

Mare or gelding 4 yrs old & over, exceeding 158cms, capable of carrying up to 12 stone 7lbs (79.5 kgs). Entries in this Class may not compete in the Small Show Hunter of the Year, and vice versa.

### **CLASS 503 - Horse of the Year Show Qualifier 2018 - Catplant Group of Companies Ltd. Middleweight Show Hunter**

Mare or gelding 4 yrs old & over, exceeding 158cms, capable of carrying up to 12 stone 7lbs (79.5 kgs) and not exceeding 14 stone (89kgs). Entries in this Class may not compete in the Small Show Hunter of the Year, and vice versa.

### **CLASS 504 - Horse of the Year Show Qualifier 2018 - Catplant Group of Companies Ltd. Heavyweight Show Hunter**

Mare or gelding 4 yrs old & over, exceeding 158cms, capable of carrying over 14 stone (89kgs). Entries in this Class may not compete in the Small Show Hunter of the Year, and vice versa.

- Classes 501-504 are qualifiers for the Horse of the Year Show, NEC, Birmingham, 3<sup>rd</sup> – 7<sup>th</sup> October 2018. Qualification will not pass below third place. Qualification will be verified by the Horse of the Year Show office.

This is a Horse of the Year Show Qualifier, all data given upon entry of this class is provided to Grandstand Media Limited and stored on the Grandstand Entries System. For full policy details please visit [www.grandstandentries.com](http://www.grandstandentries.com).

**RIDDEN HUNTER CHAMPIONSHIP (SP85)** 1<sup>st</sup> & 2<sup>nd</sup> prize-winners from the ridden hunter classes 501 – 504 to compete for **The Cottage Garden Cosmetics Perpetual Challenge Trophy**, £15 will be awarded to the champion hunter & £10 to the reserve, kindly donated by **Arbormasters**. The Champion will receive an Ashbourne Show Blouson Jacket kindly sponsored by **Pikeur & Eskadron**.

**The Ronnie Marmont 'Stanning Trophy'** - To be judged in the Main Ring by **Miss R Morley** - will be awarded to the exhibit which presents the most pleasing image of horse and rider, combining distinguished and elegant appearance, suitability and fitness of purpose with stylish performance. Two exhibits from each of the ridden hunter classes will be selected during the judging of their classes to compete for this Championship.

- A prize of £10 will be awarded to the highest placed entry in the ridden hunter classes, owned & ridden by an exhibitor residing within a radius of 25 miles of the Show Ground. All eligible entries must wear a white armband.
- **Classes 501-504 are qualifiers for The Blue Chip & IDHS(GB) £2,000 Challenge** (see regulation 22). Please state on entry form if eligible

## DRIVING CLASSES

To be judged in the Main Ring not before 11.00 am

**Judge: Mr David Capps - Lincoln**

Entry Fees: £18 (Ashbourne Shire Horse Society Members £14)

Prizes: 1<sup>st</sup> £20 2<sup>nd</sup> £18, 3<sup>rd</sup> £10, 4<sup>th</sup> £5

These classes are qualifiers for the 2018 Osborne Refrigerators BDS National Championships at Driving Addington on 22 September 2018. The highest placed turnout owned and driven by a member of the British Driving Society and eligible for the following Type-Sections disregarding those already qualified down to 6<sup>th</sup> place in the class will qualify for the 2018 Semi-Finals at Driving Addington. The Championship will immediately follow the Semi-Finals.

### Type-Sections

- c - Single non-hackney-type (excluding purebred Registered Welsh) – over 13.2hh
- d - Single non-hackney type (excluding purebred Registered Welsh) – 13.2hh & under
- f - Single Purebred Registered Welsh Cob – Section D
- g - Single Purebred Registered Welsh Ponies – Sections A, B & C
- l - Single or Tandem Turnout driven to a two-wheel exercise vehicle

**CLASS 505 – Exercise Vehicles** – Open to Horses and Ponies, 4 years old and over. A single, pair or tandem driven to a carriage of non-traditional type design and includes those with pneumatic tyres specifically designed for carriages (i.e. not car tyres). Judging will include general cleanliness, correct fitting of harness and vehicle suitability. Junior whips under 18yrs must be accompanied in the vehicle by a competent adult over 18yrs. Drivers, Grooms and Passengers who are under the age of 14 years must wear a hard hat which fits correctly.

## Horse of the Year Private Driving Classes

To be judged in the Main Ring to follow exercise vehicle class

**Judge: Mr David Capps - Lincoln**

Entry Fees: £38 - includes £12 Horse of the Year Show contribution (Ashbourne Shire Horse Society Members £30)

Prizes: 1<sup>st</sup> £50, 2<sup>nd</sup> £40, 3<sup>rd</sup> £30, 4<sup>th</sup> £20, 5<sup>th</sup> £15, 6<sup>th</sup> £10

### **CLASS 506 – Private Driving 13.2hh & under**

Ponies 13.2hh & under, 4 years and over. Open to a single, pair or tandem. Driven to a traditional type vehicle, traditional profile and identifiable type to resemble the design of a carriage built prior to the First World War. The vehicle may be made from modern materials but must have traditional style springing and carriage lamps. Pneumatic tyre vehicles, trade turnouts and show wagons are not eligible.

### **CLASS 507 – Private Driving over 13.2hh**

Horses & Ponies over 13.2hh, 4 years and over. Open to a single, pair or tandem. Driven to a traditional type vehicle, traditional profile and identifiable type to resemble the design of a carriage built prior to the First World War. The vehicle may be made from modern materials but must have traditional style springing and carriage lamps. Pneumatic tyre vehicles, trade turnouts and show wagons are not eligible.

### **Horse of the Year Private Driving Championship**

1<sup>st</sup>, 2<sup>nd</sup> & 3<sup>rd</sup> Prize winners from classes 506 & 507

**The WALLMYERS Trophy** will be awarded to the champion

Qualification for the Harness Horse & Pony of the Year Championship at The Horse of the Year Show, 3rd – 7th October 2018, National Exhibition Centre, Birmingham, will be awarded to the highest placed turnout in the Private Driving Championship down to 6th place, disregarding those already qualified. The qualifying turnout must be owned and driven by a member of the British Driving Society.

**THE EQUES-TRAIN UNAFFILIATED WORKING HUNTER**

To be judged in Ring 2 at 8.00 a.m.

**Judge – Ms Gillian Sebright – Leicestershire**

Entry Fees: £12 (Ashbourne Shire Horse Society Members £10)

Prize Vouchers kindly donated by **The Eques-Train**: 1<sup>st</sup> £20 Voucher, 2<sup>nd</sup> £15, 3<sup>rd</sup> £15, 4<sup>th</sup> £10

**CLASS 508 – The Eques-Train Unaffiliated Working Hunter**

Mare, gelding or stallion (competing stallions must have a red, white and blue ribbon displayed in their tail) 4 yrs old & over exceeding 148cms (14.2hh). Competitors in this class do not need to be registered with any society. Open to riders aged 16 or over. Fence height will be a maximum 2'9".

**The Eques-Train Championship Trophy** will be given to the winner of this class.

- This class is a qualifier for the Equestrian Life Championship Show 2018.
- **This class is a qualifier for The Blue Chip & IDHS(GB) £2,000 Challenge** (see regulation 22). Please state on entry form if eligible

**NOVICE & RESTRICTED WORKING HUNTER CLASSES**

To be judged in Ring 2 at 9.30 a.m.

**Judges:**

**Ms Rachel Thomas - Glamorgan (ride)  
Mr J Llewellyn - Glamorgan (conformation)**

Entry Fees: £18 (Ashbourne Shire Horse Society Members £14), (see regulations 18 & 19)

Prizes: 1<sup>st</sup> £20 2<sup>nd</sup> £18, 3<sup>rd</sup> £10, 4<sup>th</sup> £5

- These classes will be judged under SHB (GB) 2018 Rules (see Regulation 16). Owners, Riders and Producers of horses competing in any ridden hunter or ridden sport horse classes run in accordance with these rules must be Members of the Society. Working Hunters may complete 'Hors Concours' in Novice or Restricted Working Hunter Classes in the jumping phase only at the discretion of the show secretary but the horse cannot compete in any other Working Hunter classes for the duration of that show. **Day Ticket = £35** (this entitles competitors to compete at a maximum of 2 shows in the year – it covers owner and rider membership together with horse registration for that show). If the class is a qualifying class for RIHS, in order for the qualification to be valid, application for full owner/rider membership and horse registration must be received in the SHB(GB) office within 14 days.

**CLASS 509 - Novice Working Hunters -**

Mare, stallion or gelding, 4 years old or over, exceeding 148cms (competing stallion's must have a red, white and blue ribbon displayed in their tail). Riders any age. All rules and regulations as per the SHB (GB) 2018 Handbook. Maximum height of fences 3' 3" (1.00m).

**The K. J. Beeston Challenge Cup** will be awarded to the winner of this class

**CLASS 510 - Restricted Working Hunter**

Mare, gelding or stallion 4 years old and over (competing stallions must have a red, white and blue ribbon displayed in their tail). All rules and regulations as per the SHB (GB) 2018 Handbook. Maximum height of fences 3' 6" (1.07m).

**The R Dakin Challenge Cup** will be awarded to the winner of this class.

**These classes are qualifiers for The Blue Chip & IDHS(GB) £2,000 Challenge** (see regulation 22). Please state on entry form if eligible

## HORSE OF THE YEAR SHOW WORKING HUNTER CLASSES

To be judged in Ring 2 at 11.00 a.m.

### **Judges:**

**Ms Rachel Thomas - Glamorgan (ride)**  
**Mr J Llewellyn - Glamorgan (conformation)**

Entry Fees: £38 - includes £12 Horse of the Year Show contribution (Ashbourne Shire Horse Society Members £30)

Prizes: 1<sup>st</sup> £50, 2<sup>nd</sup> £40, 3<sup>rd</sup> £30, 4<sup>th</sup> £20, 5<sup>th</sup> £15, 6<sup>th</sup> £10

- Held under the rules of the British Show Horse Association (see regulations 20), however, Horse of the Year Show rules take precedence, a copy of which can be downloaded from [www.hoys.co.uk](http://www.hoys.co.uk). All Riders, Owners and Producers must be Members of the British Show Horse Association. Horses must be registered with the British Show Horse Association.
- Marks must be awarded in the following way:

PHASE I	(60 MARKS)
A: JUMPING POINTS	40 MARKS
B: STYLE WHILE JUMPING	20 MARKS
PHASE II	(40 MARKS)
C: CONFORMATION	20 MARKS
D: RIDE	20 MARKS
- In the event of equality, the CONFORMATION MARK from Phase II will take precedence, followed by the RIDE MARK, and then the STYLE MARK. Part One (Jumping) will be judged first, without a jump-off. All clear rounds and any other horses the judges may require will go forward to the next part. A rider can ride up to two horses in the jumping phase but then must select only one horse to take forward into the ride and conformation section if so required (no change of rider is allowed).

This class is a qualifying class for Horse of the Year Show, NEC, Birmingham, 3<sup>rd</sup> – 7<sup>th</sup> October 2018. Qualification will not pass below 3<sup>rd</sup> place. Qualification will be verified by the Horse of the Year Show office.

This is a Horse of the Year Show Qualifier, all data given upon entry of this class is provided to Grandstand Media Limited and stored on the Grandstand Entries System. For full policy details please visit [www.grandstandentries.com](http://www.grandstandentries.com).

**These classes are kindly sponsored by Sophie Knight, Equine Dentist**

### **CLASS 511 - Horse of the Year Show Qualifier 2018 – Working Hunter**

Mare, gelding or stallion (competing stallions must have a red, white & blue ribbon displayed in their tail) 4 yrs old & over exceeding 148cms (14.2hh). Any horse which has qualified as a Grade A Show Jumper or Advanced Event Horse as at 1st January in the current year is not eligible to compete in Working Hunter classes.

Fences will not exceed 1.14 m (3'9") in height. There should be a minimum of 8 fences and a maximum of 12 fences. The course must contain a combination and should contain a water tray.

- A prize of £10 will be awarded to the highest placed entry in the working hunter classes, owned & ridden by an exhibitor residing within a radius of 25 miles of the Show Ground. All eligible entries must wear a white armband.
- **This class are qualifiers for The Blue Chip & IDHS(GB) £2,000 Challenge** (see regulation 22). Please state on entry form if eligible.

**THE EQUES-TRAIN WORKING HUNTER TRAINING STAKES**

To be judged in Ring 2 at 1.30 p.m.

**Judges:**

**Mr N Vale - Sutton Coldfield  
Mrs Gillian Sebright – Leicestershire**

Entry Fee: £12 (Ashbourne Shire Horse Society Members £10)

Vouchers kindly donated by **The Eques-Train:**

1 <sup>st</sup> Prize	£20 voucher
2 <sup>nd</sup> Prize	£15 voucher
3 <sup>rd</sup> Prize	£10 voucher
4 <sup>th</sup> Prize	£5 voucher

A rosette will be awarded to each competitor

Open to horses and ponies 4 years old and over. Riders of any age. Animals may be entered in more than one class in this section. Animals will be required to jump a course of fences, they will then be asked to give a short show including a change of rein and a gallop (in Ring 4). Animals can be plaited or unplaited and in any suitable tack. The marks will be in accordance with WHP. Ponies may NOT be shown on the lead rein.

**CLASS 512 – Working Hunter Pony** 133cm and under, riders 14yrs and under, fences maximum height 2'6"

**CLASS 513 – Working Hunter Pony** Over 133cm – 153cm, riders under 20yrs, fence maximum height 2'9"

**CLASS 514 – Tiny-Tots Challenge**

Cross poles only. Open to riders 9yrs and under on the date of the show (no lead-reins).

**CLASS 515 – Training Stakes** –Maximum height of fences 2'6" (76 cms)

**NPS MOUNTAIN & MOORLAND WORKING HUNTER PONY**

To be judged in Ring 2 not before  
3.30 p.m.

**Judge: Mr Peter Boustead - Lancaster**

Entry Fees: £18 (Ashbourne Shire Horse Society Members £14)

Prizes: 1<sup>st</sup> £20 2<sup>nd</sup> £18, 3<sup>rd</sup> £10, 4<sup>th</sup> £5

**CLASS 516 –Mountain & Moorland Open W.H.P Mixed Height**

Stallions, mares & geldings 4 yrs old & over, riders any age. Ponies must jump in their correct height section. Riders may ride more than one pony providing the animals are of a different height section.

The highest placed pony from each height section will qualify provided the owner is a qualifying or life member.

- **This class is also a qualifier for the NPS/Topspec M & M Working Hunter National Championship to be held at the NPS Summer Championship 2019**
- **The Eques-Train** has kindly donated a special rosette to be awarded to the highest placed entry in this class owned & ridden by exhibitors residing within a radius of 10 miles of the Show Ground. All eligible entries must wear a white armband.
- There will be a special rosette for the best Shetland in this class.
- The class winner will receive **The Mary Froggatt Trophy**



## RIDDEN COB CLASSES

To be judged in Ring 3 at 8.00 a.m.

**Judges: Mr D Frogatt - Accrington (ride)  
Mr A Fradley - Belper (conformation)**

Entry Fees: £38 - includes £12 Horse of the Year Show contribution (Ashbourne Shire Horse Society Members £30)

Prizes: 1<sup>st</sup> £50, 2<sup>nd</sup> £40, 3<sup>rd</sup> £30, 4<sup>th</sup> £20, 5<sup>th</sup> £15, 6<sup>th</sup> £10

These classes are held under the rules of The British Show Horse Association (see regulation 19), however, Horse of the Year Show Rules take precedence, a copy of which can be downloaded from [www.hoys.co.uk](http://www.hoys.co.uk). All Riders, Owners, and Producers must be Members of the British Show Horse Association. Horses must be registered with the British Show Horse Association.

**CLASS 517 - Horse of the Year Show Qualifier 2018 – The Colosso Family Lightweight Cob of the Year** – Mare or Gelding 4 yrs old or over exceeding 148 cms but not exceeding 155 cms capable of carrying up to 14 stone.

**CLASS 518 - Horse of the Year Show Qualifier 2018 – The Colosso Family Heavyweight Cob of the Year** - Mare or Gelding 4 yrs old or over exceeding 148 cms but not exceeding 155 cms, capable of carrying more than 14 stone.

These classes are qualifiers for the Horse of the Year Show, NEC, Birmingham, 3rd - 7<sup>th</sup> October 2018. The first prize winner will qualify to compete at the final. If already qualified the second will qualify, if the first and second are already qualified then the third will go forward and so forth to fifth place. Qualification will be verified by the Horse of the Year Show Office. In accordance with BSHA Rules the annual BSHA Horse of the Year Show fee of £15 must have been paid to BSHA **before** the entry is made if the Exhibitor wishes to qualify. The BSHA Horse of the Year Show fee cannot be paid in retrospect. This fee is not the Horse of the Year Show contribution, which goes to Grandstand Media Ltd.

This is a Horse of the Year Show Qualifier, all data given upon entry of this class is provided to Grandstand Media Limited and stored on the Grandstand Entries System. For full policy details please visit [www.grandstandentries.com](http://www.grandstandentries.com).

**THE COB CHAMPIONSHIP** - 1<sup>st</sup> & 2<sup>nd</sup> prize winners from classes 517 & 518 to compete for **The Jill Bamford Trophy**. The Champion will also receive an Ashbourne Show Blouson Jacket kindly sponsored by **Pikeur & Eskadron**.

- **These classes are qualifiers for The Blue Chip & IDHS(GB) £2,000 Challenge** (see regulation 22). Please state on entry form if eligible

Entry Fees: £18 (Ashbourne Shire Horse Society Members £14)

Prizes: 1<sup>st</sup> £20, 2<sup>nd</sup> £18, 3<sup>rd</sup> £10, 4<sup>th</sup> £5

**CLASS 519 - Novice Ridden Show Cob** – Mare or Gelding 4 yrs old & over exceeding 148 cms. For eligibility see Rule 7E of the BSHA 2018 Rule Book. Non-members can apply for a Day Ticket. **Please note if sufficient entries this class will be split into Cobs and Maxi Cobs.**

**CLASS 520 - Amateur Owner/Rider Cob** - Mare or Gelding 4 yrs old & over exceeding 148 cms. Open to Horses owned and ridden by an Amateur, the Rider need not be the Owner of the Horse. For eligibility see Rule 7A-C of the BSHA 2018 Rule Book. Non-members can apply for a Day Ticket.

- **These classes are qualifiers for The Blue Chip & IDHS(GB) £2,000 Challenge** (see regulation 22). Please state on entry form if eligible

## **HORSE OF THE YEAR SHOW HACK CLASSES**

To be judged in Ring 3 at 12.00 pm

**Judges: Mr D Frogatt - Accrington (ride)  
Mr A Fradley - Belper (conformation)**

Entry Fees: £38 - includes £12 Horse of the Year Show contribution (Ashbourne Shire Horse Society Members £30)

Prizes: 1<sup>st</sup> £50, 2<sup>nd</sup> £40, 3<sup>rd</sup> £30, 4<sup>th</sup> £20, 5<sup>th</sup> £15, 6<sup>th</sup> £10

These classes are held under the rules of The British Show Horse Association (see regulation 19), however, Horse of the Year Show Rules take precedence, a copy of which can be downloaded from [www.hoys.co.uk](http://www.hoys.co.uk). All Riders, Owners, and Producers must be Members of the British Show Horse Association. Horses must be registered with the British Show Horse Association

### **CLASS 521 – Horse of the Year Show Qualifier 2018 – Brereton Small Hack**

Mare or gelding 4 yrs old & over exceeding 148cms but not exceeding 154cms

### **CLASS 522 – Horse of the Year Show Qualifier 2018 – Large Hack**

Mare or gelding 4 yrs old & over exceeding 154cms but not exceeding 160cms

These classes are qualifiers for the Horse of the Year Show, NEC, Birmingham, 3rd - 7<sup>th</sup> October 2018. The first prize winner will qualify to compete at the final. If already qualified the second will qualify, if the first and second are already qualified then the third will go forward and so forth to fifth place. Qualification will be verified by the Horse of the Year Show Office. In accordance with BSHA Rules the annual BSHA Horse of the Year Show fee of £15 must have been paid to BSHA **before** the entry is made if the Exhibitor wishes to qualify. The BSHA Horse of the Year Show fee cannot be paid in retrospect. This fee is not the Horse of the Year Show contribution, which goes to Grandstand Media Ltd.

This is a Horse of the Year Show Qualifier, all data given upon entry of this class is provided to Grandstand Media Limited and stored on the Grandstand Entries System. For full policy details please visit [www.grandstandentries.com](http://www.grandstandentries.com).

**THE HACK CHAMPIONSHIP** - 1<sup>st</sup> & 2<sup>nd</sup> prize winners from classes 521 & 522 to compete for **The Dave Bowman Leatherland Perpetual Challenge Trophy**. The Champion will also receive an Ashbourne Show Blouson Jacket kindly sponsored by **Pikeur & Eskadron**.

**Rosettes and Sashes for Champion and Reserve, and place rosettes 1<sup>st</sup> to 10<sup>th</sup> place are kindly sponsored by Su & Steph Beardmore**

## **NOVICE RIDING HORSE CLASS**

To be judged in Ring 3 at 3.00 p.m.

**Judges: Mr D Frogatt - Accrington (ride)  
Mr A Fradley - Belper (conformation)**

This class is held under the rules of the British Show Horse Association (see Regulation 20).

Entry Fees: £18 (Ashbourne Shire Horse Society Members £14)

Prizes: 1<sup>st</sup> £20 2<sup>nd</sup> £18, 3<sup>rd</sup> £10, 4<sup>th</sup> £5

**CLASS 523 - Novice Riding Horse** – Mare or Gelding 4 yrs old & over, exceeding 148cms. For eligibility see Rule 7E of the BSHA 2018 Rule Book. Non-members can apply for a Day Ticket.

**This class is a qualifier for The Blue Chip & IDHS (GB) £2,000 Challenge**  
(see regulation 22). Please state on entry form if eligible

**The Royal Bank of Scotland Salver** will be awarded to the winner of this class

## RACE HORSE TO RIDING HORSE CLASSES

To be judged in Ring 3 at 3.30 p.m.

**Judges: Mrs Jane Hubbard - Oakham**

Entry Fees: £18 (Ashbourne Shire Horse Society Members £14)

Prizes: 1<sup>st</sup> £20 2<sup>nd</sup> £18, 3<sup>rd</sup> £10, 4<sup>th</sup> £5

The class will be run under the rules of RoR (see Regulation 26)

### **Class 524 RoR OPEN in Hand Show Series Qualifier (Formally TARRA)**

Open to all RoR registered horses, 3yrs and over, fillies, mares and geldings. Horses that have raced abroad or been in training are also eligible.

Blemishes caused through racing will be ignored.

The first three horses will qualify.

This class is a qualifier for the RoR OPEN in Hand Showing Series FINAL at the RoR National Championship Show at Aintree, August 2018.

Rosettes 1<sup>st</sup> - 6<sup>th</sup>. 10

Prizes at the final- 1<sup>st</sup> £30 plus RoR jacket, 2<sup>nd</sup> £20, 3<sup>rd</sup> £10, 4<sup>th</sup> £10

### **Class 525 RoR AMATEUR Ridden Show Series Qualifier (Formally TARRA)**

Open to all RoR and NR registered horses, 4yrs and over, mares and geldings, owned, produced and ridden by an Amateur.

The Series is open to AMATEURS only – those employed in racing will be allowed to compete. Class will be judged under 'riding horse' format without 'type' being taken into consideration. Blemishes caused through racing will be ignored. The first three horses will qualify.

**The Judge will not ride at the qualifier but will ride in the final.**

This class is a qualifier for the RoR AMATEUR Ridden Show Series FINAL at the RoR National Championship Show at Aintree, August 2018.

Rosettes 1<sup>st</sup> - 6<sup>th</sup>.

Prizes at the final - 1<sup>st</sup> £40 plus RoR jacket, 2<sup>nd</sup> £30, 3<sup>rd</sup> £20, 4<sup>th</sup> £10

#### **Amateur definition:**

An amateur is a person who for the purpose of RoR classes does not/has not during the current season or previous season: Engaged in breeding, livery, buying or selling, dealing or hiring horses (for the show ring) in a commercial capacity. Horses must not have been stabled at or reside in a Professional Producer's/Trainer's yard (in the current season or previous season).

Riders must not have ridden any animals produced by a Professional/Trainer in the current or previous season.

Horses and riders must not have received any help from a Professional Producer/Trainer at a SHOW in the current or previous season. Horses must not have been ridden at a show by a rider who has ridden for a Professional/Producer Trainer in the current or previous season. Any breaches of this ruling will be taken seriously and will result in disqualification from future classes.

## NOVICE RIDDEN HUNTER & THE RIDING CLUB SHOW HORSE CLASS (Unaffiliated)

To be judged in Ring 3 at 4.15 p.m.

**Judge: Mrs Gillian Sebright - Leicestershire**

Entry Fees: £12 (Ashbourne Shire Horse Society Members £10)

### **Class 526 - Novice Ridden Hunter (Unaffiliated)**

Mare or gelding, 4years old and over, not having won a first prize of £25 or more in any ridden hunter class.

### **CLASS 527 – The Riding Club Show Horse Class**

Mare or Gelding of any type, exceeding 148cms, suitable for all Riding Club activities. To be judged 50% on manners and an individual show and 50% on conformation. Horses will walk, trot and canter on both reins as a class.

Individual shows will be performed which must include lengthened canter/gallop. Horses will not be ridden by the judge and riders will not be asked to dismount.

## **NPS RIDDEN M & M CLASSES**

To be judged in Ring 4 at 8.00 a.m.

**Judge: Mr Peter Boustead - Lancaster**

Entry Fees: £18 (Ashbourne Shire Horse Society Members £14), (see regulations 18 & 19)

Prizes: 1<sup>st</sup> £20 2<sup>nd</sup> £18, 3<sup>rd</sup> £10, 4<sup>th</sup> £5

**CLASS 528 – NPS/Showing Classics Mountain & Moorland Open Lead Rein** - Mare or gelding 4 yrs old & over not exceeding 122cms (12hh). Rider must not have attained their 9<sup>th</sup> birthday before 1<sup>st</sup> January in the current year.

- There will be a special rosette for the best Shetland in this class.

**CLASS 529 – NPS/Showing Classics Mountain & Moorland Open First Ridden** - Mare or gelding 4 yrs old & over not exceeding 128cms (12.2hh). Rider must not have attained their 12<sup>th</sup> birthday before 1<sup>st</sup> January in the current year.

- There will be a special rosette for the best Shetland in this class.

**MOUNTAIN AND MOORLAND MINI CHAMPIONSHIP** - Open to ponies that have been placed 1<sup>st</sup> or 2<sup>nd</sup> in classes 528 & 529, the winner to be awarded **The Crane Transport Perpetual Challenge Trophy**. The Champion will receive a £10 feed voucher and the Reserve a £5 feed voucher kindly donated by **SPILLERS®**.

**CLASS 530 – NPS/Ringside Mountain & Moorland Open Ridden -Dartmoor, Exmoor, Shetlands, Welsh Section A & B**- For ponies 4 yrs old & older. Rider any age.

- There will be a special rosette for the best Shetland in this class.

**CLASS 531– NPS/Ringside Mountain & Moorland Open Ridden – New Forest, Connemara, Fell, Highland, Dales, Welsh Section C & D** - For ponies 4 yrs old & older. Rider any age

**MOUNTAIN & MOORLAND OPEN RIDDEN CHAMPIONSHIP**

1<sup>st</sup> & 2nd prize winners in classes 530 & 531 to compete for the **Speedway Perpetual Challenge Trophy**.

**Ridden M & M Championship is kindly sponsored by Allison Clements  
Alvahorse products – 07976 979569**

To be judged under the Rules of the NPS. NPS Silver Medal Rosettes are only awarded when the owner of the champion pony is a **Qualifying or Life** member of the NPS. A valid membership card must be in the rider's/handler's possession on entering the ring and be produced immediately on request by either the judge or the steward. If the owner of the Champion pony is not a member, or the owner's membership card is not immediately produced, the rosette may be awarded to the Reserve Champion provided they have the required membership card. If the Champion pony has previously qualified it is still entitled to the Silver Medal Rosette but the qualification card goes to the Reserve Champion pony, provided the owner of that pony is a member of the NPS. The Silver Medal Rosette and the qualification card can be awarded no lower than first Reserve (third). Foals are not eligible for Silver Medal Championship. Qualifiers are entitled to compete in the final of the Silver Medal Rosette Championship to be held at the NPS Summer Championship Show in August **2019**

## THE EQUES-TRAIN LOCAL RIDER CLASSES

To be judged in Ring 4 at 10 a.m.

**Judge: Ms Jean Andrews - Staffordshire**

Entry Fee: £12 (Ashbourne Shire Horse Society Members £10)

Vouchers kindly donated by **The Eques-Train:**

1 <sup>st</sup> Prize	£20 voucher
2 <sup>nd</sup> Prize	£15 voucher
3 <sup>rd</sup> Prize	£10 voucher
4 <sup>th</sup> Prize	£5 voucher

A rosette will be awarded to each competitor

- Ponies/Horses in the local classes not to have won a prize of £10 or more in any affiliated showing classes prior to August in the current year & riders must reside within a radius of 25 miles of the Show Ground. Competitors will be expected to perform a short show. Classes to be judged 50/50 on rider's ability and horse's manners. Turnout will also be taken into consideration.

**CLASS 532 – Lead Rein or First Ridden** - rider under 10 yrs on the date of the show.

**The Williams and Glyns Trophy** will be presented to the winner of this class

- Rider and Pony Combinations competing in this class may NOT enter any other Local Rider classes

**CLASS 533 – Local Riders aged 14 years & under**

**CLASS 534 – Local Riders aged over 14 years**

**LOCAL CHAMPIONSHIP** - The 1<sup>st</sup> and 2<sup>nd</sup> prize winners from classes 532 & 534 to compete for the Nimrod Trophy

## OPEN IN-HAND PONIES AND HORSES

To be judged in ring 4 at 11.15am

**Ms Jean Andrews - Staffordshire**

Entry Fee: £12 (Ashbourne Shire Horse Society Members £10)

Prize Vouchers kindly donated by **The Eques-Train:** 1<sup>st</sup> £15, 2<sup>nd</sup> £13, 3<sup>rd</sup> £11, 4<sup>th</sup> £10,

**Class 535 – Open in-hand Pony** Open to any pony measuring below 13.2hh (138cm) any age

**Class 536 – Open in-hand Horse** Open to any horse measuring over 13.2hh (138.1cm) any age

*This show is a qualifier for the N.C.P.A. Pony of the Year Show in September 2018. First and second prize winners in appropriate classes will qualify.*

## RIDDEN SPORT HORSE CLASS

To be judged in Ring 2 at 12.45 a.m.

**Judge: Mr David Ingle - Northamptonshire**

Entry Fee: £18 (Ashbourne Shire Horse Society Members £14)

Prizes: Vouchers: 1<sup>st</sup> £20, 2<sup>nd</sup> £15, 3<sup>rd</sup> £10, 4<sup>th</sup> £5

A Blue Chip Cap & Qualifying rosette will be awarded to every competitor who qualifies.

- This class is run under the rules of SHB(GB) (see Regulation 16). Horses have to be registered with SHB(GB) and riders and owners must be SHB(GB) members. **Day Ticket = £35** (this entitles competitors to compete at a maximum of 2 shows in the year – it covers owner and rider membership together with horse registration for that show). If the class is a qualifying class for RIHS, in order for the qualification to be valid, application for full owner/rider membership and horse registration must be received in the SHB(GB) office within 14 days.

**Class 537 - Blue Chip Four, Five, Six Year Old & Over Flat Ridden Sport Horse** – This class is a qualifier for the Blue Chip £400 Flat Ridden Sport Horse Championship to be held at The National Hunter Supreme Championship Show (2019 at Addington Manor E C, Bucks). Horses to be shown on the flat and will not be required to jump. Snaffle bridles must be worn. Horses will not be ridden by the judge but will be required to give a short individual show of walk, trot & canter of approximately 1 minute, to be awarded marks out of a possible 20 for each pace. Lengthened strides in trot and canter must be shown. Marks, all horses are required for a conformation assessment to be awarded marks out of a possible 50. A horse may only qualify once and if already qualified the qualification will pass down the line – the best 4yro, 5yro & the best 6yro & over, enabling 3 horses to qualify for the finals per qualifying class. In the event that there are no horses from a particular age group, the qualification will pass down the line.

## MOUNTAIN & MOORLAND IN HAND CLASSES

To be judged in Ring 4 at 2.30 p.m.

**Judge: Mr Peter Boustead - Lancaster**

**The NPS/HIGHBROOK STUD M&M In Hand Summer Championship**

Entry Fee: £15 (Ashbourne Shire Horse Society Members £12)

Prizes: 1<sup>st</sup> £20, 2<sup>nd</sup> £15, 3<sup>rd</sup> £10

A rosette will be awarded to the highest placed yearling, 2 yr old and 3 yr old

Small breed classes are open to Dartmoors, Exmoors, Shetlands, Welsh A's & B's

Large breed classes are open to Connemaras, Fells, Dales, New Forest, Highland, Welsh C's & D's (See Regulation 17)

**CLASS 538 – Small Breed Yearling, 2 or 3 yr old** - colt, filly or gelding

**CLASS 539 – Small Breed Adult** - mare, stallion or gelding 4 years old or over, mare with or without a foal at foot. There will be a rosette for the best foal in this class

**The Pearlwell Perpetual Challenge Trophy** will be presented to the highest placed section A in this class.

**CLASS 540 – Large Breed Yearling, 2 or 3 yr old** - colt, filly or gelding

**CLASS 541 – Large Breed Adult** - mare, stallion or gelding 4 years old or over, mare with or without a foal at foot. There will be a rosette for the best foal in this class

**SUPREME IN HAND CHAMPIONSHIP** – 1<sup>st</sup> & 2<sup>nd</sup> prize winners from classes 538 to 541 to compete

***SUPREME IN HAND CHAMPIONSHIP KINDLY SPONSORED BY MEYNELL SADDLERY BASED  
IN BIGGIN BY HULLAND, ASHBOURNE 07970 103934***

***ALL IN HAND CHAMPIONS AND RESERVES WILL QUALIFY FROM ALL Mountain and  
Moorland classes. WINNER TO RECIEVE A SASH, JACKET, £25 VOUCHER, AND THE  
HULLAND TROPHY, RESERVE TO RECEIVE A SASH AND JACKET***

*First round qualifier for the Veteran Horse Society Supreme Final:  
VETERAN HORSE OF THE YEAR 2018  
Kindly Sponsored by Allen & Page.*

Open to members and non-members. All competitors and grooms must adhere to VHS Rules in all circumstances. Failure to do so may result in immediate disqualification.

**VHS Regional Final qualification.** All competitors placed 1<sup>st</sup> to 4<sup>th</sup> in each age category will qualify for the corresponding class at VHS Regional Finals. Members must carry their cards in the ring and have their showing card signed by the judge in the ring as proof of qualification. Non-members will receive a red qualification card which can be exchanged for signed showing card when applying for VHS membership. It is the competitors responsibility to present their Showing Card to the judge.

**Regional Finals are open to members only.**

All competitors are eligible to enter open classes at the National Veteran Championships, September 2018 No qualification or membership necessary. See VHS website for schedule.

For further information please visit the VHS website [www.veteran-horse-society.co.uk](http://www.veteran-horse-society.co.uk) or telephone the VHS Show Office on 01239 881300 or 07789 514004.

**CLASS 542**      **VETERAN IN-HAND, COMBINED AGE CLASS** (15 years and over).  
To be run as one class but judged as separate age categories:  
Diamond Veteran (25 years and over), Veteran (20–24 years) & Pre-Veteran (15–19 years). Open to horses and ponies of any breed and height.

**CLASS 543**      **VETERAN RIDDEN, COMBINED AGE CLASS** (15 years and over).  
To be run as one class but judged as separate age categories:  
Diamond Veteran (25 years and over), Veteran (20–24 years) & Pre-Veteran (15–19 years). Open to horses and ponies of any breed and height.

*Optional*

**MOUNTAIN & MOORLAND COMBINED AGE CLASS - Ridden** (15 years and over) To be run as one class but judged as separate age categories Qualification to the Regional Final in relevant age category:

**MOUNTAIN & MOORLAND COMBINED AGE CLASS - In-hand** (15 years and over) To be run as one class but judged as separate age categories Qualification to the Regional Final in relevant age category:

Ashbourne Show would like to Thank All our kind  
and generous Sponsors

Allison Clements - AlvaHorse, Arbormasters,  
Meynell Saddlery, Motifs, Poole House Vets,  
Shaws Equestrian, Sophie Knight – Equine  
Dentist, Spillers, Su & Steph Beardmoore  
and The Eques-Train

## REGULATIONS FOR THE SOCIETY'S SHOW

### **Personal Information Consent - Entrants**

In order to provide a professional and effective service to competitors and entrants to Ashbourne Show, we need to keep a record of personal information. This is information such as your name, contact details and age, and possibly those of family members if appropriate. You may also provide us with dietary or other medical information that will allow us to ensure your safety and convenience whilst at Ashbourne Show.

The Ashbourne Shire Horse Society respects your privacy and will only use your data for the provision, communication and processing of your entry and other requirements and for providing you with information regarding future Shows and events. Entrants information will be published within the Show Catalogue, and provided to the relevant breed societies and professional and regulatory bodies as necessary and prize-winners will be listed on our website and elsewhere. We will not otherwise share your personal data with other third parties without your prior consent unless required to do so by law. All personal information is treated as private and confidential, it is recorded electronically on a database and/or in a paper file. You have the right to see any information that we hold about you, and to have your details removed.

**Consent:** I have read and understood the information above. I confirm that I am permitted to provide personal information about any other person included in this entry and I give written consent for The Ashbourne Shire Horse Society to hold and to use this personal information in order to provide entrant/competitor services to me safely and efficiently.

1. All exhibits must be bona-fide property of the exhibitor and carry the correct number.
2. All exhibitors are reminded that they compete at their own risk and that they should have legal liability insurance.
3. The judge's decision shall be final and the Council reserves the right to withhold any prizes if, in the opinion of the judges, the exhibits do not possess sufficient merit.
4. **All prize money will be paid out on the day of the show from the cash office. Prize Money will be allocated as follows 1<sup>st</sup>, 2<sup>nd</sup> and 3<sup>rd</sup> prizes will all be paid in all classes. 4<sup>th</sup> 8-12, 5<sup>th</sup> 13-17, and 6<sup>th</sup> 18 plus entries. money WILL NOT be paid out without the prize money voucher awarded in the ring. Any uncollected prize money will be forfeited. Please note prize money will not be paid out until 1 hour after a class has ended. Any disputes must be addressed with the Light Horse Secretary and may be resolved after the show.**
5. The Society reserves the right to alter the schedule at its discretion or to merge classes if there are insufficient exhibitors. Entry fees will be refunded for any event cancelled.
6. Any exhibitor wishing to lodge a protest in respect of any animal exhibited at the show in the Light Horse Section must do so in writing within 60 minutes of completion of the class together with a deposit of £20. This sum shall be forfeited if, on investigation by the Council, the protest is not sustained.
7. The Council will not hold itself responsible for any loss or accident whatsoever which may occur on the showground and all entries shall be deemed to have been made on this understanding.
8. Acknowledgement of entry forms, together with the necessary tickets, will be sent by the Secretary to enable exhibitors to check their entries have been received. If you do not receive this acknowledgement at least 7 days before the show, please contact the Light Horse Secretary.
9. Competitors are requested to take particular note of the times of their classes and to be ready in the collecting ring.
10. The Society reserves the right to have measured any horse or pony where there is a height stipulation and where certificates issued under the Joint Measurement Scheme cannot be produced as evidence of height. Where applicable, competitors may also be requested to produce birth certificates as proof of age.
11. EQUINE PASSPORTS/INFLUENZA VACCINATION CERTIFICATES. Exhibitors are required to have Passports for all horses/ponies when competing at the show and up to date Equine Influenza Inoculation Certificate for each of their exhibits. Any exhibitor found without a passport or valid certificates for all their animals will be asked to leave the Showground. Please ensure you have proof of this as random checks will be made.
12. All foals must be at least 3 weeks old. Stallions and colts 2 yrs old or over must hold a Ministry of Agriculture, Breed Society or NPS Stallion licence, unless otherwise governed by their individual breed society. All handlers of stallions and colts 2 yrs old and over must be 14 yrs old or over.
13. **If late entries are accepted, double the entry fee will be charged, in accordance with the terms and conditions shown under the entry rules listed in this schedule**
14. Hard hats in accordance with breed society rules must be worn at all times when mounted. In unaffiliated classes all riders must wear hats that meet current safety standards when mounted. Anyone aged 14 or under must wear protective headgear.



**15.** The Society reserves the right to postpone, cancel, abandon, or curtail the Show due to 'force majeure' or otherwise at its absolute discretion. In no circumstances shall the Society be liable, in contract, tort (including negligence or breach of statutory duty) or otherwise howsoever, and whatsoever the cause thereof (i) for any loss of profit, business, contracts, revenues, or anticipated savings, or (ii) for any special indirect or consequential damage or losses of any nature whatsoever. For the purposes of this Condition, '*Force Majeure*' means fire, explosion, flood, lightning, Act of God, act of terrorism, war, rebellion, riot, sabotage, or official strike or similar official labour dispute, or events or circumstances outside the reasonable control of the Society.

**16.** Classes 509, 510 & 537 are affiliated to The Sports Horse Breeding of Great Britain. The SHB(GB) requires all entries in these classes to be entered on their basic identity register.

- 1 The Basic identity register is a one off lifetime register & the costs are:
  - A) Foal £35 (basic identity)
  - B) Older Horses £35 (basic identity)
  - C) Overstamp of any other society's recognised passport £30
- 2 The Show Hunter registration is for horses competing in a ridden qualifying class which is currently £40 for the horse and £75 for the owner & rider.
- 3 **Day Ticket = £35** (this entitles competitors to compete at a maximum of 2 shows in the year – it covers owner and rider membership together with horse registration for that show). If the class is a qualifying class for RIHS, in order for the qualification to be valid, application for full owner/rider membership and horse registration must be received in the SHB(GB) office within 14 days.

It is strongly recommended that competitors aged 18 or over wear correctly secured Skull Caps/Riding Hats that meet one of the following current Safety Standards: All PAS 015; VG1; ASTM F1163 04a onwards; SNELL E2001; AS/NZS 3838 2003 onwards. It is mandatory for competitors under the age of 18 to wear such skull caps or hats. In the jumping phase of working hunter classes the aforementioned skull caps/riding hats must be worn.

**17.** Mountain and Moorland in hand ponies must be registered with their respective breed society to be eligible to compete & registration numbers must be stated on the entry form.

**18.** The pony's breed society registration number must be stated when entering Heritage classes.

**19.** Classes 501-504, 511 & 517-522, 523 are held under the rules of the British Show Horse Association. Horses must be registered with the Association and all Owners, Producers and Riders must be Association Members. Riders must be 15 years of age or older. Registration numbers must be quoted on the entry form.

Horses competing at the Horse of the Year Show and qualifying shows in The Hunter sections of The Sport Horse Breeding of Great Britain classes at their Affiliated Shows cannot compete in Hack, Cobs and Riding Horse classes at the same show, on the same day and vice versa. This does not apply to SHB (GB) Ridden Sport Horse classes.

The three highest placed prize winners in all **Open** Affiliated classes will qualify to compete in the BSHA Classic Supreme classes at the National Championship Show 2018. With the exception of Hoys Hunter qualifiers.

Day Tickets - Non-Members may purchase a Day Ticket for classes 519, 520 & 523. They can have up to a maximum of 2 Day Tickets per Exhibitor, per Horse, per Rider, per season. A Day Ticket will allow entry into Amateur, Home Produced, In-Hand, Novice, Working, Young Rider and Open Affiliated classes only, **but will NOT allow entry into RIHS or HOYS qualifying classes.** Horses registered on a Day Ticket do not require a JMB height certificate. Competitors can apply for a Day Ticket by downloading an application form from the BSHA website.

The BSHA offer a Novice, Amateur and Young Rider Rosette in each Open class and a champion rosette for each section (with the exception HOYS Hunter classes). The Association will award an Amateur Home Produced rosette in all Affiliated **Open** cob classes (light and heavyweight only). These Cob rosettes have been kindly sponsored by TSG, Mr L Turley. The awards will go down the line; there is no limit on how many of these rosettes can be claimed in a year. Please state on your entry form if you are eligible for these.

**20.** The Horse of the Year Show Ridden Hunter and Working Hunter Classes, 501-504, 511 & 523 are affiliated to The British Show Horse Association. Owners, Producers and riders must be members of the BSHA and all horses must be registered with the BSHA. Registration numbers must be quoted on entry form. Horses competing at the Horse of the Year Show and qualifying shows in The Hunter sections of The Sport Horse Breeding of Great Britain classes at their Affiliated Shows cannot compete in Hack, Cobs and Riding Horse classes at the same show, on the same day and vice versa. This does not apply to SHB (GB) Ridden Sport Horse classes. Competitors must enter their horses in the appropriate weight section, but the judges shall have the power to transfer exhibits to a different section if they deem it necessary. Any horse which has qualified as a Grade A Showjumper or Advanced Event horse as at the 1<sup>st</sup> January in the current year is not eligible to compete in working hunter classes.

**21.** This show is a Qualifier for the Blue Chip & Irish Draught Horse Society (GB) £2,000 Challenge. The highest placed horse (not already qualified) from each of the following classes:

- Ridden Hunters
- Working Hunters (inc novice, restricted and unaffiliated)
- Novice Riding Horse
- Cobs (including novice and amateur)

will qualify for the Final of the Blue Chip & IDHS (GB) £2,000 Challenge which will be held at the IDHS (GB) Annual Breed Show in 2018. **N.B: A horse may only qualify for the Final once, regardless of the type or number of classes won, placed in or entered.** Each qualifier will receive a card and a £10 voucher from Blue Chip. ***Qualifiers are required to complete an online form at [www.idhs.gb.com](http://www.idhs.gb.com) to inform the IDHS (GB) that they have qualified for the Final.*** In the Final, the Champion will be awarded £1,000 prize money, a trophy and a Blue Chip rug. The Reserve Champion will be awarded £500 and 3rd to 7th inclusive will be awarded £100 each. In addition, the highest placed Pure Bred Irish Draught will receive a trophy, the highest placed Sport Horse will receive a trophy and £50 and £100, the highest placed 158cm (15.2hh) and under will receive a trophy and £50, and the highest placed Amateur Produced and Ridden Horse will receive a silver salver and a rug

**22.** Classes 524-525 run under the rules of the RoR and all those entering horses and/or participating in the show agree to be bound by the Retraining of Racehorses Rules and Regulations from time to time in force. Horses should be ridden in a snaffle, pelham or simple double bridle. Horses should be plaited. All entries **MUST** be registered with the RoR and include their registration number on the entry form and have **RACED in GB**. All those entering horses and/or participating in the show agree to be bound by the RoR Rules and Regulations from time to time in force. Please be aware that the show will split the class on the horse's last run in a race (NH or Flat) or will provide 2 ride judges should the entries exceed 20. Please mark your entry form accordingly. **Competitors must wear a safety/kite mark hard hat with a chinstrap. Racing injuries and blemishes will NOT be ignored in this series**

**23.** In the Private Driving classes, all horses and ponies to be 4yrs old and over. **Young Driver –** The driver must be aged 10 years or over on the first day of the show at which they are to compete. A driver under the age of 18 must accompanied in the vehicle by a competent and responsible person aged 18 years or over, a "responsible adult". Proof of age will be required if necessary. It is the responsibility of the owner/driver (if over 18) or (if the owner/driver is under 18) the responsible adult to ensure that his/her groom/s is/are competent for the purpose of attending to the turnout and aged 10 or over on the day of the show. When in the vehicle grooms, passenger/s and driver must have their feet firmly on the floor of the vehicle or use a suitable fixed footrest. The regulations apply at all times and in all areas of the showground. **Hard Hat Ruling –** All drivers/grooms/passengers under the age of 14 years must wear a correctly fitted hard hat when in a carriage or in attendance to a turnout.

**24.** NPS Qualifying Rounds: These classes are judged under the Rules of the NPS. Ponies must be registered in the main body of their respective Mountain & Moorland Stud Books. Part bred are not eligible for Mountain & Moorland Classes.

Qualifying rounds for most NPS competitions are open to ponies owned by NPS members and non-members but only ponies owned by adult NPS Qualifying or Life members are eligible to qualify for the final of the competition at the NPS Summer Championship Show at Malvern from 31st July -2nd August 2019

The highest placed pony, if owned by an NPS member, in each class will qualify for the final. Qualification may pass down to third place if the first and second ponies are already qualified.

NPS/Rosettes Direct Home Produced Ridden Championship - Riders of Home Produced ponies (see definition in the NPS Rules Book) can wear a white arm band in classes where this is indicated. These ponies, if owned by NPS members, are then eligible to qualify for the final at the NPS Summer Championship Show. The Owner's Membership cards **MUST** be produced in the ring when requested or the qualification will be forfeit.

**25. Any competitor or animal on the showground deemed to be rude, dangerous, out of control or being mistreated can be approached and dealt with by any official of the Ashbourne Show.**

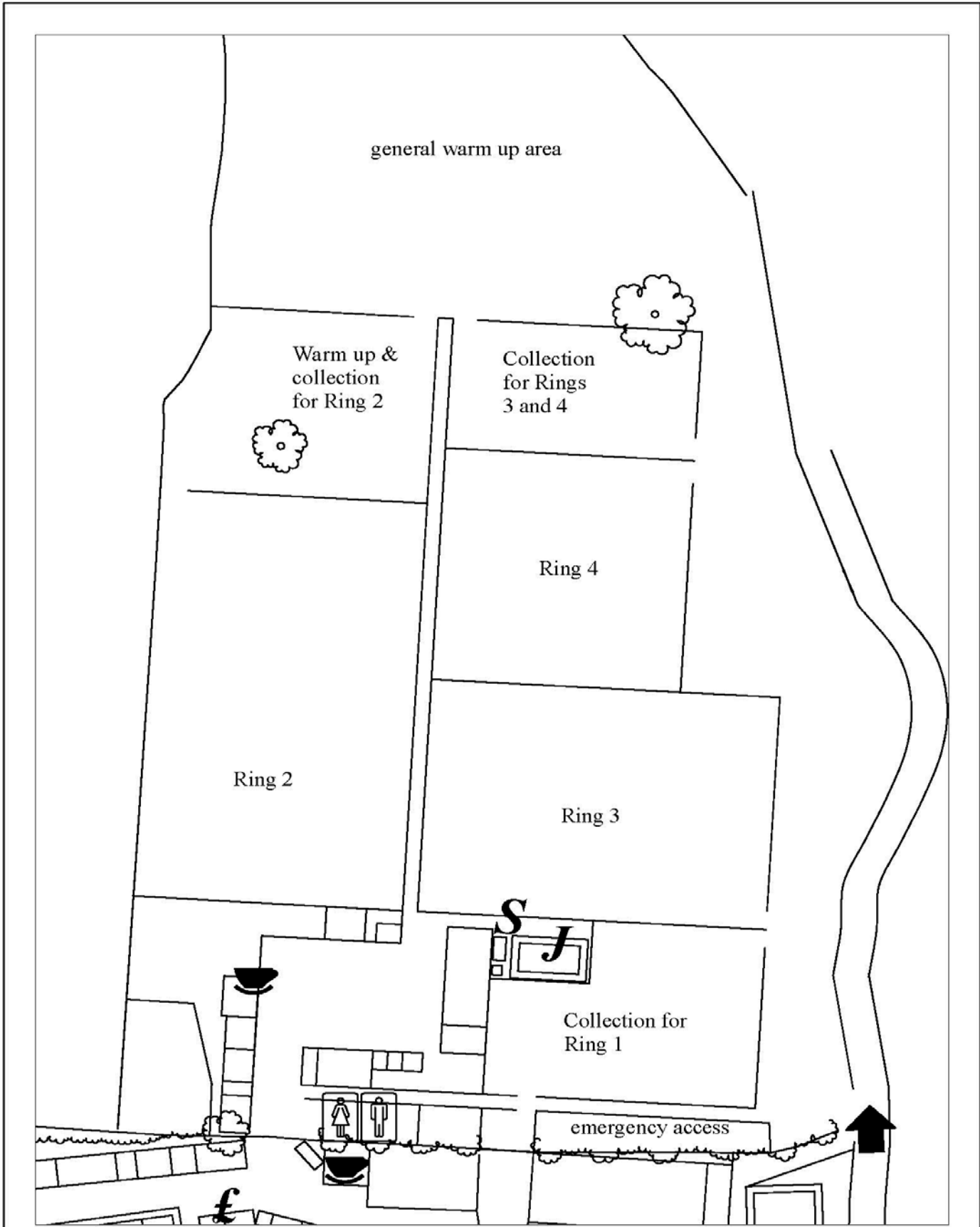

*S* Secretary  
*J* Judges' marquee

Light Horse rings plan - 2018  
 Not to scale

# C·W·SELLORS

## Fine Jewellery

Proud sponsors of  
**Ashbourne Show**

C W Sellors, 2 Victoria Square,  
Ashbourne, Derbyshire DE6 1GG

Tel: 01335 342 002  
Email: ashbourne@cwsellors.com

[www.cwsellors.com](http://www.cwsellors.com)  
[www.cwsellorswatches.co.uk](http://www.cwsellorswatches.co.uk)

*Gemstone Jewellery • Diamonds • Watches  
Wedding Rings • Charms & Gifts • Repairs  
Unwanted Jewellery Purchased*



**WINNERS**  
MOST INNOVATIVE USE  
OF GEMSTONES  
2010 • 2008 • 2007

**IJL** INTERNATIONAL  
JEWELLERY  
LONDON  
& The Gemmological Association  
of Great Britain